

PARTS LIST			
ITEM	QTY	PART NUMBER	DESCRIPTION
1	1	9820-1182-1	HINGE BASE PLATE
2	1	9820-1182-2	HINGE PIN - 98 O/A
3	1	GREASE NIPPLE	GREASE NIPPLE
4	1	9820-1182-3	HINGE MAIN PLATE

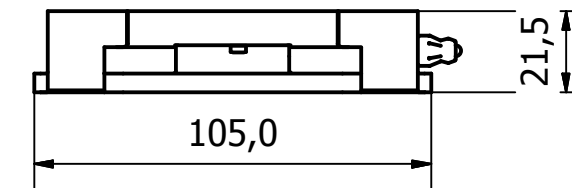
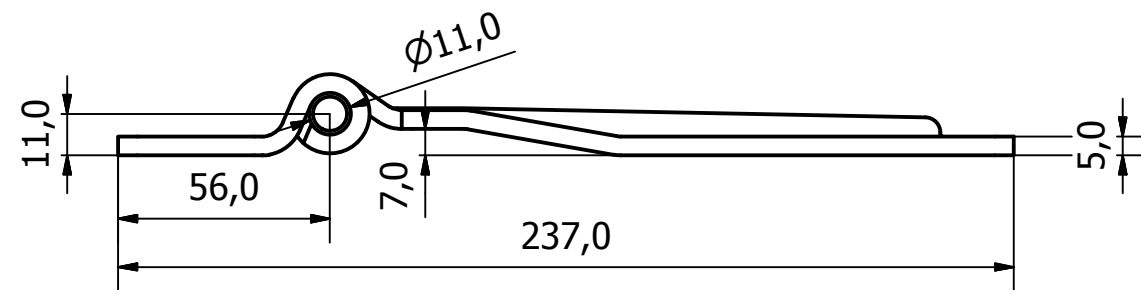
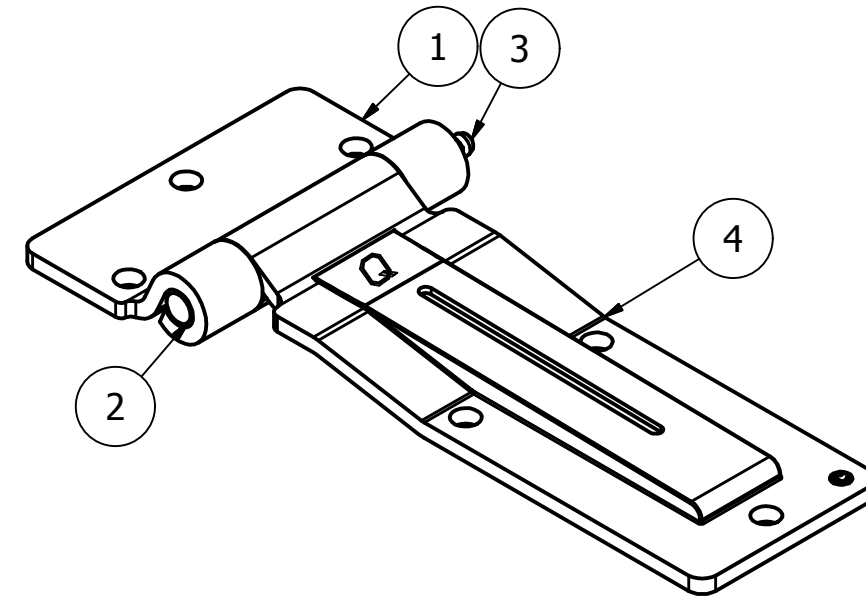
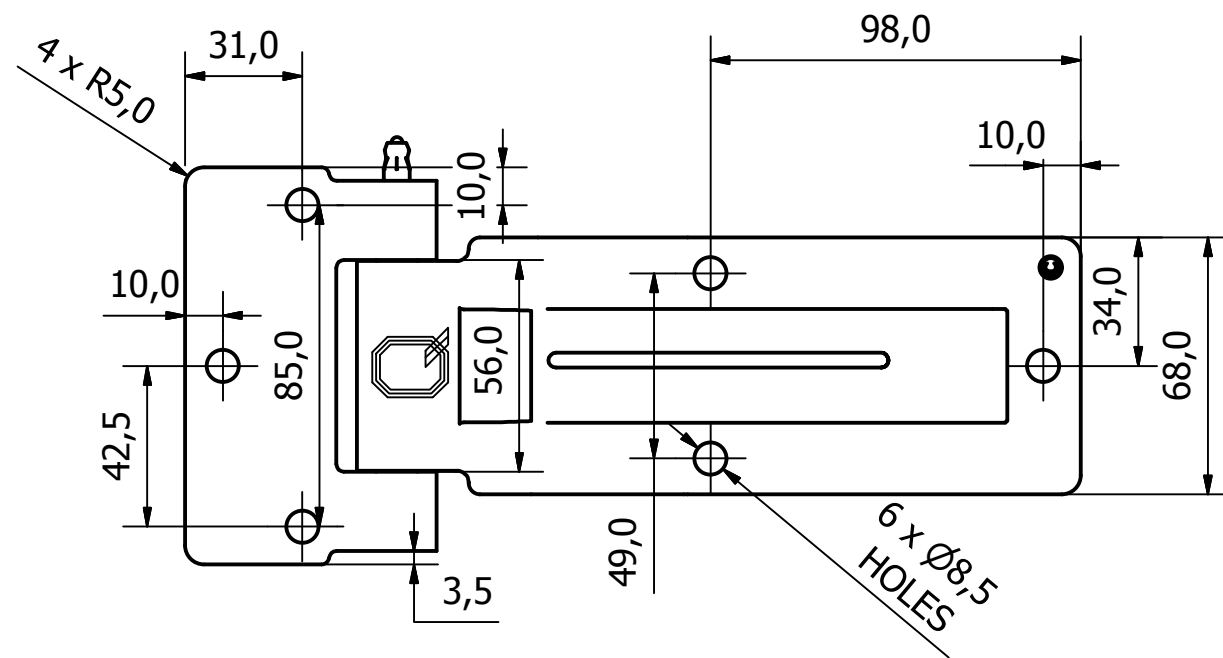

NOTE:  
HINGE DESIGNED FOR 180° APPLICATIONS  
BUT WILL ROTATE THROUGH TO 270°

GENERAL TOLERANCES ON LENGTHS
0.5 - 6 ± 0.1mm
6 - 30 ± 0.2mm
30 - 120 ± 0.3mm
120 - 400 ± 0.5mm
400 - 1000 ± 0.8mm
1000 - 1200 ± 1.2mm
2000 - 4000 ± 2.0mm

WALSALL
---------

DRAWN BY U.F	CHECKED BY A.P
-----------------	-------------------

SCALE 1:2	MATERIAL -
--------------	---------------

MASS 0.929 kg	FINISH Z/C PASSIVATE
------------------	----------------------------

Date 22/09/2016
--------------------

ALL DIMS IN MM UNLESS STATED DO NOT SCALE	A3
---	----

1	VALIDATION COMPLETE	25/10/16	A.P
REV	DESCRIPTION	DATE	APPROVED
	PRESSED STEEL HINGE - CRANKED BLADE C/W GREASE NIPPLE LH		
	9820-1182	Edition 1	Sheet 1 / 1